



# Demand response with KiWi Power

**KiWi Power is the only demand response aggregator providing businesses access to a full suite of grid balancing services.**

Demand response is a unique and powerful application used by National Grid to reduce electricity consumption at peak times across industrial and commercial clients. Commercial sites are paid to participate and contribute to a greener, more cost effective grid reducing the need for inefficient backup power stations and providing vital balancing requirements.

KiWi Power is a partner of National Grid and aggregates assets from multiple sites during peak times to help balance the grid. We combine innovative technology and proprietary hardware and software to allow industrial and commercial clients to use existing energy assets to participate in a wide portfolio of revenue generating demand response programmes.

## What is STOR?

Short Term Operating Reserve (STOR) is National Grid's core programme for securing reserve on the national electricity network. KiWi Power and our network of clients act as a 'virtual power station' aggregating assets from multiple sites in order to reduce stress on the grid at peak times.

### KiWi Power STOR Programme Parameters:

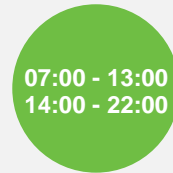

Programme times



Number of events

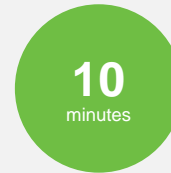

Notification time

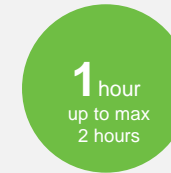

Typical event duration

- ✓ No enabling costs
- ✓ Monthly statements
- ✓ Quarterly payments
- ✓ No performance penalties

## Why is your business participating?



A significant recurring annual revenue



Real-time energy monitoring



Maintain operational readiness



Improve your green credentials



No site disruption to core business

# A STOR event with KiWi Power

## Initiating an event

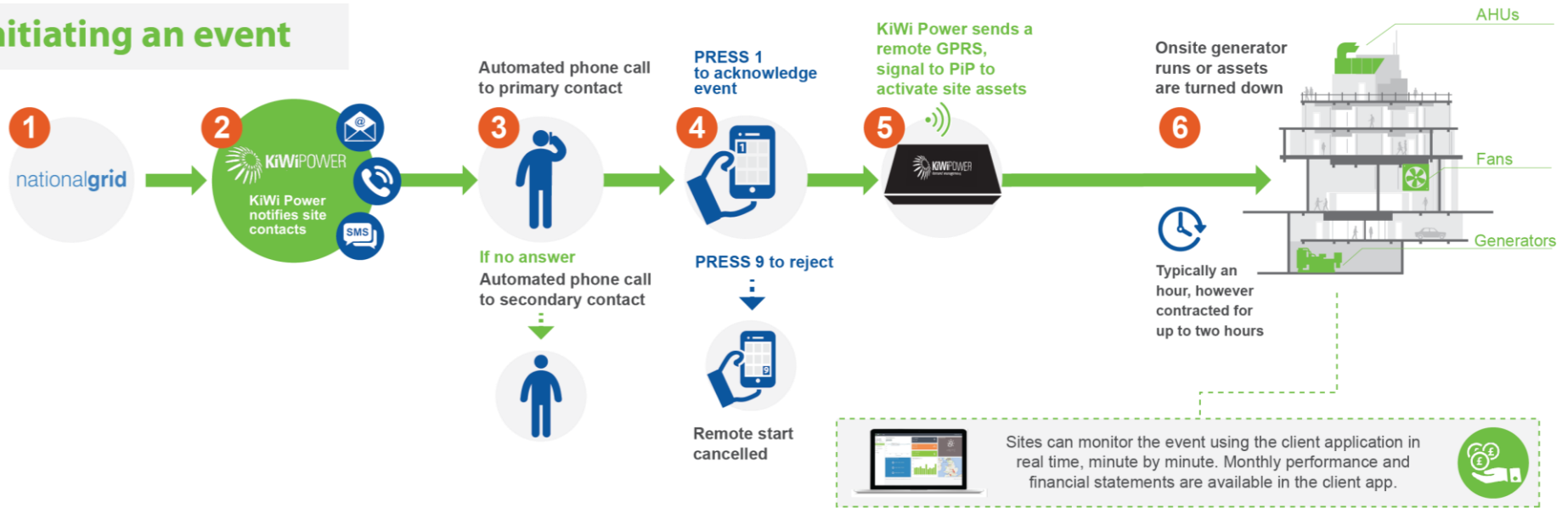

## Ending an event

